











## FL10 Lubricator – Standard



### Features

- Stainless Steel Construction Handles Most Corrosive Environments
- 1/8" Female Threaded Drain
- Fillable Under Pressure
- Meets NACE Specifications MR-01-75/ISO 15156
- High Flow: 1/2" - 100 SCFM §

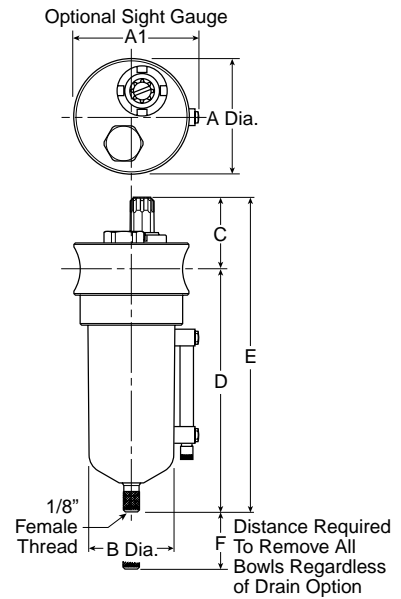

Port Size	NPT	
	Metal Bowl Without Sight Gauge	Metal Bowl With Sight Gauge
1/2"	<b>FL10-04DSS</b>	<b>FL10-04WSS</b>

FL10 Lubricator Dimensions		
<b>A</b>	<b>A1</b>	<b>B</b>
2.38 (60)	2.50 (64)	1.75 (44)
<b>C</b>	<b>D</b>	<b>E</b>
1.81 (46)	5.00 (127)	6.81 (173)
<b>F</b>		
3.50 (89)		

Standard part numbers shown bold. For other models refer to ordering information below.

§ SCFM = Standard cubic feet per minute at 90 PSIG inlet and 5 PSIG pressure drop.

inches  
(mm)

### Ordering Information

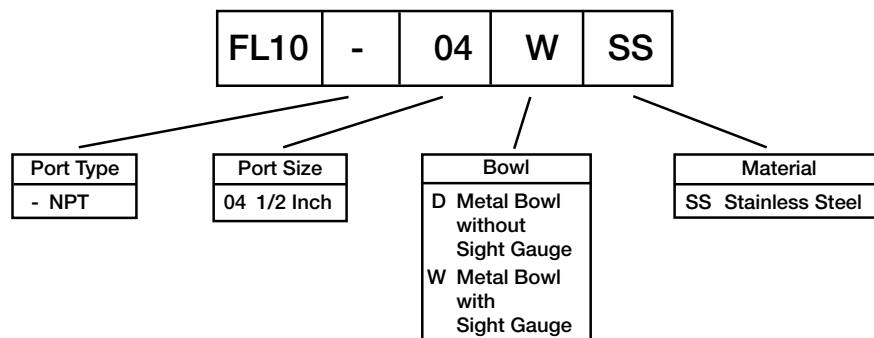

Operation

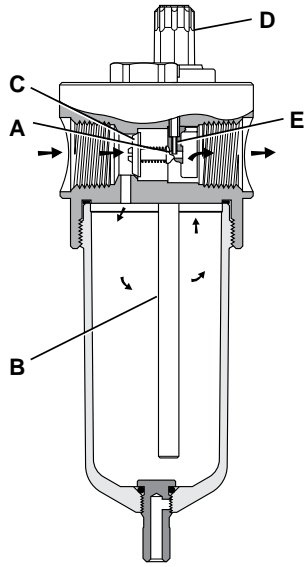

Air flowing through the unit goes through two paths. At low flow rates the majority of the air flows through the Venturi section (A). The rest of the air opens the check valve (C). The velocity of the air flowing through the Venturi section (A) creates a pressure drop. This lower pressure allows the oil to be forced from the reservoir through the pickup tube (B) and travels up to the metering screw (D). The rate of oil delivery is then controlled by adjusting the metering screw (D). Oil flows past the metering screw (D) and forms a drop in the nozzle tube (E). As the oil drops through the dome (F) and back into the Venturi section (A), it is broken up into fine particles. It is then mixed with the air flowing past the check valve (C) and is carried downstream. As the air flow increases the check valve (C) will open more fully. This additional flow will assure that the oil delivery rate will increase linearly with the increase of air flow.

Technical Information

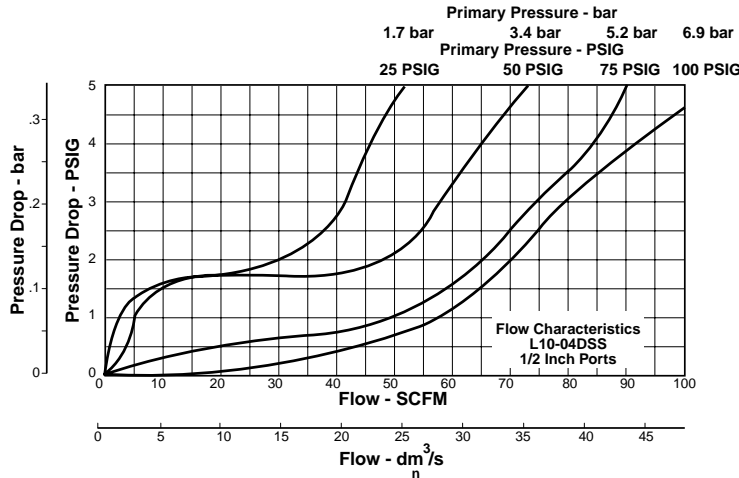

FL10 Lubricator Kits & Accessories

- Drain Kit – Manual Twist Drain .....SA600Y7-1SS
- Pipe Nipple – 1/2" 316 Stainless Steel.....616A28-SS
- Sight Dome Kit ..... RKL10SS

Specifications

- Bowl Capacity .....4.0 Ounces
- Port Threads ..... 1/2 Inch
- Pressure & Temperature Ratings –
  - Metal Bowl (D).....300 PSIG Max (20.7 bar) 0°F to 150°F (-18°C to 66°C) Auto Drain Ratings
  - Metal Bowl (W).....0 to 250 PSIG (0 to 17.2 bar) 0°F to 150°F (-18°C to 66°C)

Note: Air must be dry enough to avoid ice formation at temperatures below 32°F (2°C).

Weight ..... 1.9 lb. (0.85 kg)

Materials of Construction

- Body ..... 316 Stainless Steel
- Bowl ..... 316 Stainless Steel
- Dip Tube ..... 316 Stainless Steel
- Drain ..... 316 Stainless Steel
- Fill Plug ..... 316 Stainless Steel
- Seals ..... Fluorocarbon
- Sight Dome ..... Nylon
- Sight Gauge ..... Isoplast



## P3NL Mist Lubricators – Hi-Flow



### Features

- Port blocks (PB) available to provide 1½" port extension to 1" ported bodies.
- Proportional oil delivery over a wide range of air flows.
- Bowl can be filled while air line is under pressure.
- Transparent sight dome for 360° visibility.
- High Flow: 3/4" – 240 SCFM<sup>§</sup>  
 1" – 250 SCFM<sup>§</sup>  
 1½" – 260 SCFM<sup>§</sup>

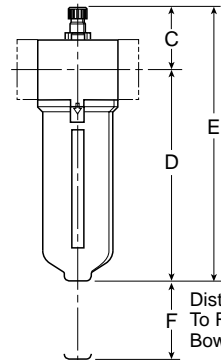
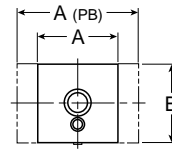

Port Size	NPT
	No Drain
Metal Bowl / Sight Gauge	
3/4"	P3NLA96LSN
1"	P3NLA98LSN
1½" #	P3NLA9PLSN

P3NL Lubricator Dimensions		
A	A <sub>PB</sub>	B
3.62 (92)	5.91 (150)	3.62 (92)
C	D	E
2.81 (71)	9.00 (229)	11.81 (300)
F		
4.92 (125)		

# 1" Port Body with 1-1/2" Port Block.

§ SCFM = Standard cubic feet per minute at 90 PSIG inlet and 5 PSIG pressure drop.

Inches (mm)

## Ordering Information

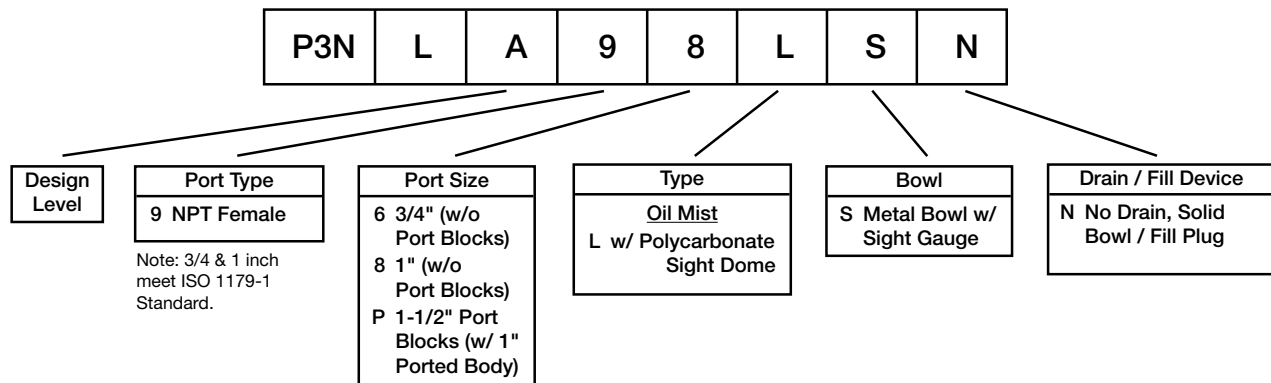



**Technical Information**

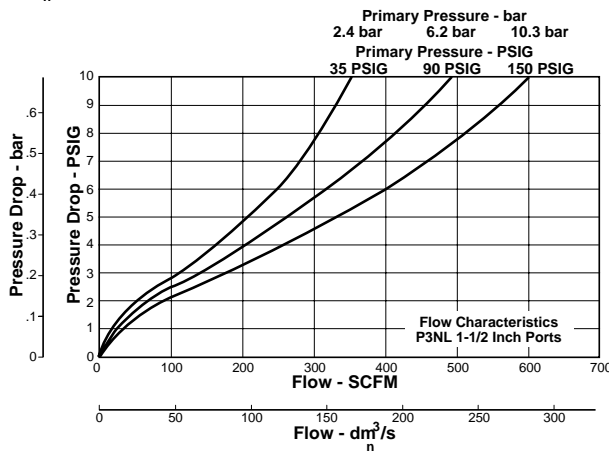
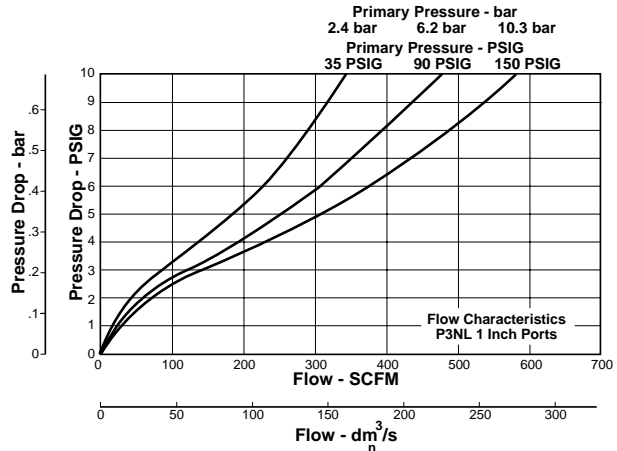
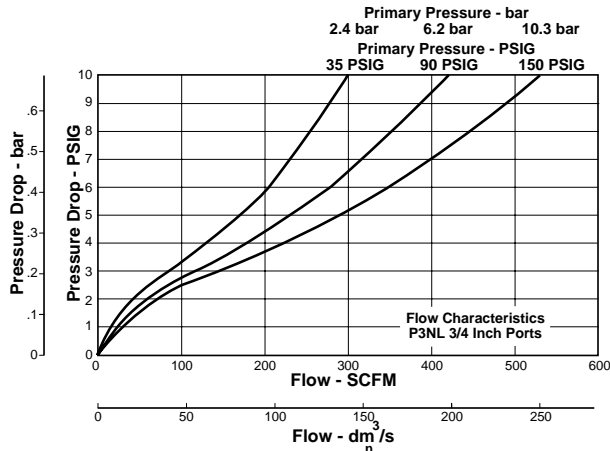

**P3NL Lubricator Kits & Accessories**

- Adjustment Knob ..... P04121
- Bowl Kits –
  - Metal Bowl – Sight Gauge / Twist Drain ..... P3NKA00BSM
  - Metal Bowl – Sight Gauge / No Drain ..... P3NKA00BSN
- Bowl Latch Kit ..... C11A33
- Drain Kit – Twist Drain ..... PS512P
- Fill Cap Kit ..... P3NKA00PL
- Sight Dome Kit – Polycarbonate ..... PS740P
- Nylon ..... PS740N
- Sight Gauge Kit ..... P3NKA00PE
- Pressure Fill Adapter Kit ..... P3NKA00PK
- Service Kit ..... P3NKA00RL
- Mounting Bracket Kit\* ..... P3NKA00MW
- Oil – 1 Gal. .... F442002P
- 12 Quart Case ..... F442003P
- 4 Gallon Case ..... F442005P

**Specifications**

- Bowl Capacity ..... 18.0 Ounces
- Minimum Flow for Lubrication ..... 6.6 SCFM at 100 PSIG
- Pressure & Temperature Rating ..... 0 to 250 PSIG (0 to 17.2 bar)
- 32°F to 175°F (0°C to 80°C)
- Suggested Lubricant ..... F442 Oil
- Petroleum based oil of 100 to 200 SSU viscosity
- at 100°F and an aniline point greater than 200°F
- (DO NOT USE OILS WITH ADDITIVES,
- COMPOUNDED OILS CONTAINING SOLVENTS,
- GRAPHITE, DETERGENTS, OR SYNTHETIC OILS.)
- Weight – 3/4 Inch ..... 3.5 lb. (1.6 kg)
- 1 Inch ..... 3.5 lb. (1.6 kg)
- 1-1/2 Inch† ..... 4.6 lb. (2.1 kg)

**Materials of Construction**

- Body, Bowl ..... Aluminum
- Drains: Twist Drain (Optional) ..... Plastic
- Injector Meter Block & Base Assembly ..... Plastic
- Seals ..... Nitrile
- Sight Dome ..... Polycarbonate
- Sight Gauge ..... Polyamide (Nylon)

† 1" Port Body with 1-1/2" Port Block.

