

Replacement Filter Elements

Technical Data	pg. 6-2
Filter Media Specifications	pg. 6-4
Standard Polyester/Paper Elements	
35-6600 SCFM Flow Range	pg. 6-6
Small Vacuum Pump Elements (800 Series)	
3-375 CFM Flow Range	pg. 6-8
Blower Elements / Special Sized Elements	pg. 6-10
Hockey Puck Filter Elements	
3-250 SCFM Flow Range	pg. 6-12
Custom Configurations / Slip Fit	pg. 6-13
Oil Mist Coalescing Elements	
4-1800 SCFM Flow Range	pg. 6-14
Specialty Air/Oil Separators	
Spin On Separators	pg. 6-15
Top Hat Style Separators	pg. 6-15
Element Reference Chart	pg. 6-16
SpinMeister™ Precleaners	pg. 6-18



Replacement Elements 35 - 6600 SCFM Flow Range



Small Elements
with Molded Endcaps



Compact & Large Elements
with Metal Endcaps

Features

- Pleated media for high dirt holding capacity
- Polyester: Reinforced with epoxy coated steel wire on both sides of cloth
- Paper: Heavy duty industrial strength paper surrounded by heavy gauge galvanized expanded metal
- 40 - 50% increased dust loading capacity with prefilter (part number suffix P)
- Optimal surface area per given size

Technical Specifications

- Polyester: 99%+ removal efficiency to 5 micron
- Paper: 99%+ removal efficiency to 2 micron
- Temp (continuous): min -26°F (-15°C), max 220°F (104°C)
- Filter change out differential: 15-20" H₂O over initial ΔP

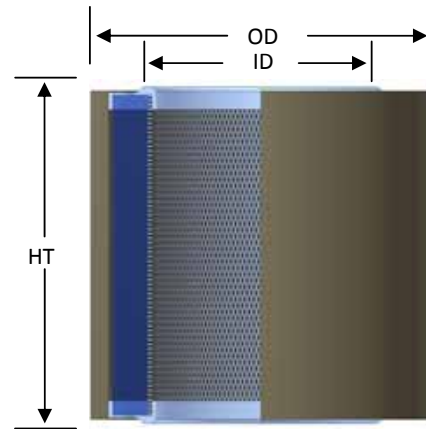

Polyester Media Benefits

- Washable with lukewarm water & mild detergent
- Less maintenance due to longer durability
- Moisture resistant
- Handles hot air and oil mist from unload cycle of reciprocating/piston compressor

Paper Media Benefits

- Optimal surface area per given size
- Higher efficiency than many alternative media
- Cost effective



Replacement Elements 35 - 6600 SCFM Flow Range

Replacement Elements—up to 300 SCFM flow

Element Part Number		Element SCFM Rating	Surface Area ft ²		Dimensions - inches			STD Endcap
Polyester	Paper		Polyester	Paper	ID	OD	HT	Features
15P	14P	35	0.50	1.12	3	4 3/8	2 5/16	M
19P	18P	100	1.50	3.00	3	4 3/8	4 3/4	M
31P	30P	195	2.30	6.20	3 5/8	5 3/4	4 3/4	M
35P	34P	275	4.00	11.00	4 3/4	7 7/8	4 13/16	M
231P	230P	300	4.50	11.8	3 5/8	5 3/4	9 1/2	M

Note: Also available in wire mesh. Example part number for wire mesh: 230S

Dimension tolerance $\pm 1/4"$

See Element Technical Data section for maintenance guidelines

Replacement Elements—up to 6600 SCFM flow

Element Part Number		Element SCFM Rating	Surface Area ft ²		Dimensions - inches			STD Endcap
Polyester	Paper		Polyester	Paper	ID	OD	HT	Features
235P	234P	570	8.3	22.8	4 3/4	7 7/8	9 5/8	M
335P	334P	800	12	34	4 3/4	7 7/8	14 1/2	M
237	236	550	8.6	22.6	4 2/3	7 3/4	8 1/2	GBN
239P	238P	570	11.5	52	4 7/8	9 1/4	10	GBN
245P	244P	880	14	35.5	6	9 3/4	9 5/8	GN M
345P	344P	1100	22.1	57	6	9 3/4	14 1/2	GN
275P	274P	1100	19	45.4	8	11 3/4	9 5/8	GN
375P	374P	1500	28	68.1	8	11 3/4	14 1/2	GN
377P	376P	1825	50	125	9	14 5/8	14 1/2	GN
385P	384P	3300	50	140	14	19 5/8	14 1/2	GN
485P	484P	4705	75	200	14	19 5/8	21 1/2	GN
685P	--	6600	100	--	14	19 5/8	28 1/2	GN

Note: Most are available in wire mesh. Example part number for wire mesh: 244S

Dimension tolerance $\pm 1/4"$

See Element Technical Data section for maintenance guidelines

Endcap Information

- M = Molded plastisol
- B = Closed one end with bolt hole, open on other end
- G = Galvanized metal endcaps
- N = Neoprene gaskets on open end(s)

Additional Media Options

- 1, 4, 25, and 100 micron Polyester
- HEPA
- Stainless steel wire mesh
- High temperature Nomex
- Stainless steel Nomex reinforced by stainless steel wire mesh & expanded metal
- Polypropylene
- Activated carbon

Small Vacuum Pump Elements 3 - 375 SCFM Flow Range

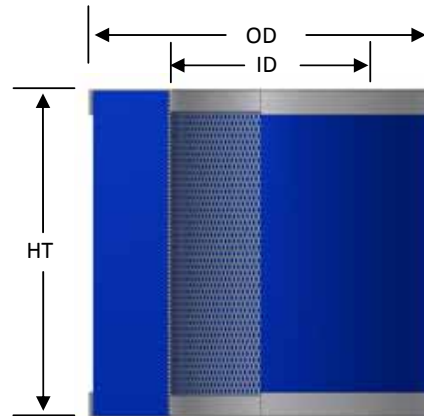

Features

- Pleated media for high dirt holding capacity
- Polyester: Reinforced with epoxy coated steel wire on both sides of cloth, expanded metal I.D.
- Paper: Heavy duty industrial strength paper surrounded by heavy gauge galvanized expanded metal O.D.
- 40 - 50% increased dust loading capacity with prefilter (part number suffix P)
- Optimal sealing surface & design

Polyester Media Benefits

- Washable with lukewarm water & mild detergent
- Less maintenance due to longer durability
- Moisture resistant
- Handles hot air and oil mist from unload cycle of reciprocating/piston compressor

Technical Specifications

- Polyester: 99%+ removal efficiency to 5 micron
- Paper: 99%+ removal efficiency to 2 micron
- Temp (continuous): min -26°F (-15°C), max 220°F (104°C)
- Filter change out differential: 15-20" H₂O over initial ΔP

Paper Media Benefits

- Optimal surface area per given size
- Higher efficiency than many alternative media
- Cost effective

Additional Media Options

- 1, 4, 25, and 100 micron Polyester
- HEPA
- Stainless steel wire mesh
- High temperature Nomex
- Stainless steel Nomex reinforced by stainless steel wire mesh & expanded metal
- Polypropylene



Small Vacuum Pump Elements 3 - 375 SCFM Flow Range

Paper Replacement Elements—800 Series

Solberg Part Number	Mann Ref Number	SCFM Rating	Surface Area ft ²	Dimensions - inches			STD Endcap Features
				ID	OD	HT	
800	C31	3	0.14	3/8	1 1/8	1 3/16	GB
802	C31/1	5	0.22	3/8	1 1/8	1 1/2	GB
804	C32	9	0.35	3/8	1 1/8	2 7/16	GB
806	C42/1	8	0.33	1/2	1 1/2	1 1/2	GB
808	C42/2	4	0.18	1/2	1 1/2	1 1/8	GB
810	C43	13	0.55	1/2	1 1/2	2 7/16	GB
812	C44	8	0.33	1/2	1 1/2	1 1/2	GC
814	C64/1	13	0.55	11/16	2 5/16	1 9/16	GB
816	C64/3	13	0.55	11/16	2 5/16	1 9/16	GC
818	C66	20	0.89	11/16	2 5/16	2 7/16	GB
820	C66/1	18	0.76	11/16	2 5/16	2	GB
822	C74	7	0.29	1	2 11/16	1	TF1
824	C75	25	0.92	1 1/2	2 1/2	2 11/16	GC
826	C75/2	20	0.86	1 1/2	2 1/2	2 13/16	TCF
828	C76/2	12	0.48	1 1/2	2 1/2	1 3/4	GC
830	C79/1	24	0.91	1	2 1/2	2 7/8	GB
832	C79/2	19	0.82	1 1/2	2 1/2	2 11/16	GCF
834	C713	40	1.5	1 1/2	2 1/2	4 1/2	GBHF
836	C718	48	1.8	1 1/2	2 1/2	6 9/16	GBHF
838	C912	30	1.2	2 3/8	3 5/16	2 3/4	TCF
840	C1049	80	3.5	1 3/4	3 5/8	5 5/8	G
842	C1112	55	1.7	2 3/8	3 7/8	2 3/4	G
844	C1112/2	55	1.8	2 3/8	3 7/8	2 3/4	GCF
846	C1132	62	2.7	2 3/8	3 7/8	3 15/16	G
848	C1337	115	5	2 9/16	5	4 3/4	G
850	C15124/1	290	14	3 1/2	5 7/8	8 3/4	GR
852	C711/1	24	0.97	1 1/2	2 11/16	2 3/4	TC
854	C411	27	1.1	1/2	1 1/2	5 5/16	GB
856	C26240	375	17	7 11/16	10	7 11/16	T
858	C1574	110	1.3	3 1/2	5 7/8	4 7/8	G
862	C21138/1	322	14	5 11/16	8 3/8	6 7/16	M
868	N/A	25	1	2 3/8	3 11/16	2 15/16	M
870	C69/1	30	1.2	1 1/8	1 15/16	5 5/8	GB
872	C75/2	24	0.93	1 1/2	2 1/2	2 13/16	GBF
874	N/A	180	6	6	8 1/2	3 1/2	GCF
878	N/A	115	5	2 9/16	5	4 3/4	GB
896	N/A	115	5.24	2 3/8	4	8 7/16	GB

Polyester Replacement Elements—800 Series

Solberg Part Number	Mann Ref Number	SCFM Rating	Dimensions - inches			STD Endcap Features
			ID	OD	HT	
821	C66/1	18	11/16	2 5/16	2	GB
825	C75	25	1 1/2	2 1/2	2 11/16	GC
827	C75/2	20	1 1/2	2 1/2	2 13/16	TCF
841	C1049	80	1 3/4	3 5/8	5 5/8	G
843	C1112	55	2 3/8	3 7/8	2 3/4	G
845	C1112/2	55	2 3/8	3 7/8	2 3/4	GCF
847	C1132	62	2 3/8	3 7/8	3 15/16	G
849	C1337	115	2 9/16	5	4 3/4	G
851	C15124/1	290	3 1/2	5 7/8	8 3/4	GR
857	C26240	375	7 11/16	10	7 11/16	T
859	C1574	110	3 1/2	5 7/8	4 7/8	G
863	C21138/1	322	5 11/16	8 3/8	6 7/16	M
879	N/A	115	2 9/16	5	4 3/4	GB
897	N/A	115	2 3/8	4	8 7/16	GB

Endcap Information

- B = Closed one end w/bolt hole
- C = Closed one end
- F = Felt gaskets on open end(s)
- G = Galvanized metal endcaps
- H = Felt gasket on bolt hole
- I = Injection molded santoprene
- M = Molded plastisol
- N = Neoprene gaskets on endcaps
- R = Mixed Rubber/cork gasket EC's
- T = Tin plated metal endcaps
- 1 =1 gasket only

See Element Technical Data section for maintenance guidelines. Dimension tolerance $\pm 1/4"$

Note: Model offerings and design parameters may change without notice. See www.solbergmfg.com for most current offering.



Filter Elements Blower Elements/Special Sizes

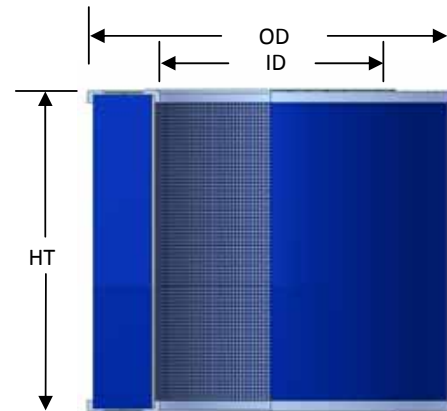

Features

- Pleated media for high dirt holding capacity
- Polyester: Reinforced with epoxy coated steel wire on both sides of cloth
- Paper: Heavy duty industrial strength paper surrounded by heavy gauge galvanized expanded metal
- 40 - 50% increased dust loading capacity with prefilter (part number suffix P)

Polyester Media Benefits

- Washable with lukewarm water & mild detergent
- Less maintenance due to longer durability
- Moisture resistant
- Handles hot air and oil mist from unload cycle of reciprocating/piston compressor

Technical Specifications

- Temp (continuous): min -26°F (-15°C), max 220°F (104°C)
- Filter change out differential: 15-20" H₂O over initial Δ P
- Polyester: 99%+ removal efficiency standard to 5 micron
- Paper: 99%+ removal efficiency standard to 2 micron

Paper Media Benefits

- Optimal surface area per given size
- Higher efficiency than many alternative media
- Cost effective



Filter Elements Blower Elements/Special Sizes

Common Filter Elements for the Blower Industry

Solberg			Solberg			Dimensions - inches			STD
Part Number	Universal	EM	Part Number	Universal	EM	ID	OD	HT	Endcap Features
Polyester	Ref. Number	Ref. Number	Paper	Ref. Number	Ref. Number				
32-01	81-1202	---	32-00	81-0470	---	4	5 13/16	2	M
32-03	81-1203	F642	32-02	81-0471	P642	4 1/4	6	2 1/2	M
32-05	81-1204	F974	32-04	81-0472	P974	7 1/4	9 3/4	4	M
32-07	81-1205	F976	32-06	81-1063	P976	7 1/4	9 3/4	6	M
32-09	81-1206	F1197	32-08	81-0474	P1197	9 7/8	11 1/2	7	M
32-11	81-1207	F13118	32-10	81-0475	P13118	11 5/8	13 5/8	8 5/8	M
32-13	81-1209	F171310	32-12	81-1163	P171310	13	17	10	M
32-15	81-1210	F231914	32-14	81-1164	P231914	19	23	14	M

Solberg		Solberg		Dimensions - inches			STD
Part Number	Stoddard	Part Number	Stoddard	ID	OD	HT	Endcap Features
Polyester	Ref. Number	Paper	Ref. Number				
32-17	F8-151	32-16	F8-108	4 3/4	6 7/8	4 3/16	M
32-19	F8-135	32-18	F8-109	7 1/8	10 3/16	5 1/8	M
32-21	F8-134	32-20	F8-110	9 1/2	12 9/16	4 7/8	M
32-23	F8-139	32-22	F8-111	9 1/2	12 9/16	10	M
32-25	F8-148	32-24	F8-137	15	19 3/4	14	M

Note: Contact factory for availability . Also available in wire mesh.

Endcap Information

G = Galvanized metal endcaps

M = Molded plastisol

N = Neoprene gaskets on endcaps

Special Sized Filter Elements

Element Part Number		Rated Flow SCFM	Surface Area ft ²		Dimensions - inches			STD Endcap Features
Polyester	Paper		Polyester	Paper	ID	OD	HT	
09	08	15	0.25	0.45	1 1/8	2 1/4	2 1/4	GN
21NP	-	80	1.7		2 3/8	4 1/4	4 3/4	M
25	24	105	2.0	4.7	3 5/8	5 7/8	4	M
-	80P	175		7.1	4 1/8	7 7/8	3	M
-	84P	255		10	4 1/8	7 7/8	4	M
45P	44P	430	6.9	17	6	9 3/4	4 3/4	M
-	144P	560		20	6	9 3/4	5 13/16	GN
75P	74P	560		21	8	11 3/4	5	GN
371P	370P	1800		70	10	13 3/4	14 1/2	GN
391	390	5500	100	275	22 1/4	27 7/8	14 1/2	GN
491	490	8000	145	400	22 1/4	27 7/8	21 1/2	GN
571P	-	3000	100		10	13 3/4	24 1/2	GN
575P	-	2500	84		8	11 3/4	24 1/2	GN
-	100	50		2.3	1 1/4	3 7/8	2 3/4	M
-	101	120		5.7	4 1/2	6 5/8	5 1/8	M
-	102	85		3.3	5 11/16	7 3/4	3	M
-	104	150		7.1	5 1/8	7 1/4	5 3/8	M
-	108	60		3.0	3 5/8	5 3/4	2 3/4	M
-	109	170		6.8	5 5/8	7 3/4	4	M
-	126	100		2.1	4 3/4	6 1/2	2 1/8	GN
-	127	35		1.0	3	4 3/8	2 1/8	M

See Element Technical Data section for maintenance guidelines.

Dimension tolerance ± 1/4"



Hockey Puck Elements

3 - 250 SCFM Flow Range

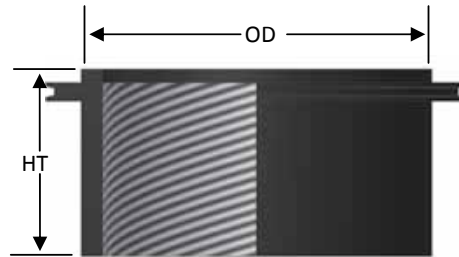

Features

- High grade filter element
- Element construction of injection molded santoprene
- Integrated gasket seal
 - Positive seal between housing hemispheres
 - New seal with each element
 - Minimizes parts
- Optimal surface area per given size
- Pleated media for high dirt holding capacity

Technical Specifications

- Temp (continuous): min -26°F (-15°C), max 220°F (104°C)
- Filter change out differential: 15-20" H2O over initial Δ P

Options

- Multiple configurations: elliptical, round, special shapes
- Molding materials: PVC, Urethane

Polyester Media Benefits

- 99%+ removal efficiency standard to 25 micron
- Washable with lukewarm water & mild detergent
- Less maintenance due to longer durability
- Moisture resistant
- Handles hot air and oil mist from unload cycle of reciprocating/piston compressor

Paper Media Benefits

- 99%+ removal efficiency standard to 2 micron
- Heavy duty industrial strength paper
- Higher efficiency than many alternative media
- Cost effective

Replacement Element Sizes

Element Part Number		Element SCFM Rating	Surface Area ft ²	Dimensions - inches	
Polyester	Paper			OD	HT
03	02	3	0.1	1 1/2	1
05	04	8	0.2	2 1/4	1
07	06	12	0.58	3	1 3/8
11	10	35	1.1	4	1 3/8
17	16	250	8	8	3 1/4

See Element Technical Data section for maintenance guidelines

Tidbit: Charlie Solberg Jr. created a patented process to manufacture our Hockey Puck Style Filter Elements.



Custom Configurations / Slip Fit Elements

Custom Configurations For Hockey Puck Style Elements

- Contact Solberg for custom configurations that fit your equipment or application
- High grade filter element
- Multiple molding material options
- Integrated gasket seal
- Tooling and production minimums may apply

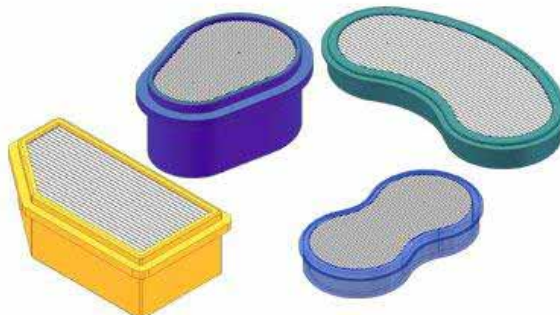

Sample Configurations

Applications

- Small engines
- Industrial equipment
- Vacuum cleaners
- DIY equipment
- Contact Solberg about your unique application

Disposable Filter Elements

AKG Series “Slip Fit” Elements

Features

- Molded plastisol slip-fit connection
- Less maintenance with disposable element
- Pleated media for high dirt holding capacity



Technical Specifications

- Temp (continuous): min -26°F (-15°C), max 220°F (104°C)
- Filter change out differential: 15-20" H₂O over initial Δ P
- Polyester: 99%+ removal efficiency standard to 5 micron
- Paper: 99%+ removal efficiency standard to 2 micron

Oil Mist Coalescing Elements/ Air Separator Elements

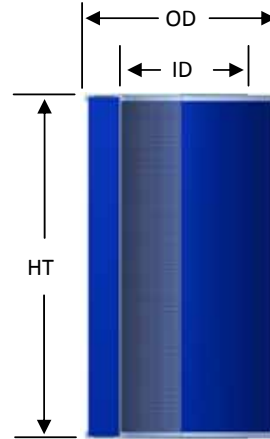

Features

- Reinforced with epoxy coated steel wire
- Expanded metal support on both sides of media

Benefits

- High efficiency at low pressure drop
- Increased surface area in a given volume allows for low velocity separation of ultra-fine oil mists
- High gravimetric efficiency means low oil carryover
- Environmentally friendly sealing material

Technical Specifications

- 0.3 micron media; 99.97% efficiency
- Continuous operating temp: 68°F (20°C) - 180°F (80°C)

Feature Identification

- M = Molded plastisol endcap
- B = Endcaps have closed one end with bolt hole, open on other end
- G = Galvanized metal endcaps
- C = Closed one end, open on other end
- D = Element with molded open end, metal closed
- W = Wrapped coalescing media
- P = Pleated coalescing media

Element Part Number	Element SCFM Rating	Dimensions - inches			Features
		ID	OD	HT	
FG3	4	1 1/4	2 1/4	2 1/8	MW
FG5	5	1 1/4	2 1/4	3	MW
FG7	7	1 1/4	2 1/4	4	MW
FG9	16	3	4	4	MW
FG10	24	3	4	6	MW
FG11	30	3 7/8	5	4 1/4	MW
FG20	44	8	9	4 3/4	MW
FG24	55	8	9	6	MW
GL910	4	1/2	1 13/16	1 7/16	DW
GL915	10	3/4	2 5/16	2 3/8	DW
PSG925	20	1 1/2	3	4 7/8	GBP
PSG848	50	2 9/16	5	4 3/4	GP
PSG850/1	125	3 1/2	5 7/8	8 3/4	GBP
PSG145	175	2 9/16	5	14 1/4	GP
PSG860/1	200	3 1/2	5 7/8	14	GBP
PSG244/2	300	6	9 3/4	9 5/8	GBP
PSG344/2	500	6	9 3/4	14 1/2	GBP
PSG374/2	800	8	11 3/4	14 1/2	GBP
PSG474/2	1100	8	11 3/4	21 1/2	GBP
PSG476	1800	9	14 5/8	21 1/2	GP



Air /Oil Separators Spin On / Top Hat

Spin On Separator Elements For Compressors, LG Series

- Used on Rotary & Piston Compressors
- Maximum operating pressure: 20 bar
- Elements withstand pressure differences up to 5 bar
- At 7 bar operating pressure the pressure drop at nominal flow is approx. 0.2 bar
- Zinc-plated steel housing and endcaps with zinc passivated flange.
- Glass Media for efficient air/oil separation
- Oil residual content of the compressed air can attain up to 3 ppm separation efficiency
- Temp (continuous): min -40°F (-40°C) max 248°F (120°C)
- Contact factory for specific flows and sizes.



Top Hat Style Separator Elements For Compressors & Vacuum Systems

- Multi-stage gas/oil separator element
- Pleated fiberglass filter media
- Outside-In flow path
- Optimal surface area to flow ratio
- Corrosion resistant material
- Wide range of operating flows
- Minimal oil carryover
- Flat gaskets for optimal sealing
- 99.97% efficiency for 0.3 micron oil mist
- Saturated pressure differential: 1.5 - 2.5 PSID
- Oil carryover concentration: 2.5 - 3.75 mg/m³ (2-3 PPM)
- Temperature rated: 225°F (110°C)
- Service life depends upon pre-separation and contamination of the oil & compressed gas
- Electrical continuity throughout element
- Contact factory for specific flows and sizes.



Options

- Wrapped media
- Special gasket material
- Stainless steel construction
- Stainless steel or copper grounding connections

Element Reference Chart

Standard Polyester / Paper



Solberg Part Number	Dimensions			Media Type	SCFM Rating	Endcap Features	Reference Number	Reference Number	Catalog Page
	HT	OD	ID						
03	1	1 1/2	---	Polyester	3	M			6-12
02	1	1 1/2	---	Paper	3	M			6-12
05	1	2 1/4	---	Polyester	8	M			6-12
04	1	2 1/4	---	Paper	8	M			6-12
822	1	2 11/16	1	Paper	7	TF1	C74		6-9
808	1 1/8	1 1/2	1/2	Paper	4	TB	C42/2		6-9
800	1 3/16	1 1/8	3/8	Paper	3	TB	C31		6-9
07	1 3/8	3	---	Polyester	12	M			6-12
06	1 3/8	3	---	Paper	12	M			6-12
11	1 3/8	4	---	Polyester	35	M			6-12
10	1 3/8	4	---	Paper	35	M			6-12
802	1 1/2	1 1/8	3/8	Paper	5	TB	C31/1		6-9
806	1 1/2	1 1/2	1/2	Paper	8	TB	C42/1		6-9
812	1 1/2	1 1/2	1/2	Paper	8	TC	C44		6-9
814	1 9/16	2 5/16	11/16	Paper	13	TB	C64/1		6-9
816	1 9/16	2 5/16	11/16	Paper	13	TC	C64/3		6-9
828	1 3/4	2 1/2	1 1/2	Paper	12	TC	C76/2		6-9
821	2	2 5/16	11/16	Polyester	18	TB	C66/1		6-9
32-01	2	5 13/16	4	Polyester	---	M	81-1202		6-11
32-00	2	5 13/16	4	Paper	---	M	81-0470		6-11
820	2	2 5/16	11/16	Paper	18	TB	C66/1		6-9
126	2 1/8	6 1/2	4 3/4	Paper	170	GN			6-11
127	2 1/8	4 3/8	3	Paper	60	M			6-11
09	2 1/4	2 1/4	1 1/8	Polyester	30	GN			6-11
08	2 1/4	2 1/4	1 1/8	Paper	30	GN			6-11
15P	2 5/16	4 3/8	3	Polyester	35	M			6-7
14P	2 5/16	4 3/8	3	Paper	35	M			6-7
804	2 7/16	1 1/8	3/8	Paper	9	TB	C32		6-9
810	2 7/16	1 1/2	1/2	Paper	13	TB	C43		6-9
818	2 7/16	2 5/16	11/16	Paper	20	TB	C66		6-11
32-03	2 1/2	6	4 1/4	Polyester	---	M	81-1203	F642	6-11
32-02	2 1/2	6	4 1/4	Paper	---	M	81-0471	P642	6-11
824	2 11/16	2 1/2	1 1/2	Paper	25	TC	C75		6-9
832	2 11/16	2 1/2	1 1/2	Paper	19	TCF	C79/2		6-9
825	2 11/16	2 1/2	1 1/2	Polyester	25	TC	C75		6-9
852	2 3/4	2 11/16	1 1/2	Paper	24	TC	C711/1		6-9
838	2 3/4	3 5/16	2 3/8	Paper	30	TCF	C912		6-9
100	2 3/4	3 7/8	1 1/4	Paper	85	M			6-11
842	2 3/4	3 7/8	2 3/8	Paper	55	T	C1112		6-9
843	2 3/4	3 7/8	2 3/8	Polyester	55	T	C1112		6-9
845	2 3/4	3 7/8	2 3/8	Polyester	55	TCF	C1112/2		6-9
108	2 3/4	5 3/4	3 5/8	Paper	105	M			6-11
844	2 3/4	3 7/8	2 3/8	Paper	55	TCF	C1112/2		6-9
826	2 13/16	2 1/2	1 1/2	Paper	20	TCF	C75/2		6-9
872	2 13/16	2 1/2	1 1/2	Paper	24	TBF	C75/2		6-9
827	2 13/16	2 1/2	1 1/2	Polyester	20	TCF	C75/2		6-9
830	2 7/8	2 1/2	1	Paper	24	TB	C79/1		6-9
868	2 15/16	3 11/16	2 3/8	Paper	25	M			6-9
102	3	7 3/4	5 11/16	Paper	145	M			6-11
80P	3	7 7/8	4 1/8	Paper	300	M			6-11
17	3 1/4	8	---	Polyester	250	M			6-12
16	3 1/4	8	---	Paper	250	M			6-12
874	3 1/2	8 1/2	6	Paper	180	TCF			6-9
846	3 15/16	3 7/8	2 3/8	Paper	62	T	C1132		6-9
847	3 15/16	3 7/8	2 3/8	Polyester	62	T	C1132		6-9
25	4	5 7/8	3 5/8	Polyester	180	M			6-11
24	4	5 7/8	3 5/8	Paper	180	M			6-11
109	4	7 3/4	5 5/8	Paper	290	M			6-11
84P	4	7 7/8	4 1/8	Paper	435	M			6-11
32-05	4	9 3/4	7 1/4	Polyester	---	M	81-1204	F974	6-11
32-04	4	9 3/4	7 1/4	Paper	---	M	81-0472	P974	6-11
32-17	4 3/16	6 7/8	4 3/4	Polyester	---	M	F8-151		6-11
32-16	4 3/16	6 7/8	4 3/4	Paper	---	M	F8-108		6-11
834	4 1/2	2 1/2	1 1/2	Paper	40	TBHF	C713		6-9
19P	4 3/4	4 3/8	3	Polyester	100	M			6-7
18P	4 3/4	4 3/8	3	Paper	100	M			6-7
848	4 3/4	5	2 9/16	Paper	115	T	C1337		6-9
878	4 3/4	5	2 9/16	Paper	115	TB			6-9
849	4 3/4	5	2 9/16	Polyester	115	T	C1337		6-9
879	4 3/4	5	2 9/16	Polyester	115	TB			6-9
31P	4 3/4	5 3/4	3 5/8	Polyester	195	M			6-7
30P	4 3/4	5 3/4	3 5/8	Paper	195	M			6-7
45P	4 3/4	9 3/4	6	Polyester	735	M			6-11
44P	4 3/4	9 3/4	6	Paper	735	M			6-11

Endcap Information

- B = Closed one end w/bolt hole
- C = Closed one end
- F = Felt gaskets on open end(s)
- G = Galvanized metal endcaps
- H = Felt gasket on bolt hole
- I = Injection molded santoprene
- M = Molded plastisol
- N = Neoprene gaskets on endcaps
- R = Mixed Rubber/cork gasket EC's
- T = Tin plated metal endcaps
- 1 =1 gasket only



Element Reference Chart Standard Polyester / Paper

Solberg Part Number	Dimensions			Media Type	SCFM Rating	Endcap Features	Reference Number	Reference Number	Catalog Page
	HT	OD	ID						
35P	4 13/16	7 7/8	4 3/4	Polyester	275	M			6-7
34P	4 13/16	7 7/8	4 3/4	Paper	275	M			6-7
858	4 7/8	5 7/8	3 1/2	Paper	110	T	C1574		6-9
859	4 7/8	5 7/8	3 1/2	Polyester	110	T	C1574		6-9
32-21	4 7/8	12 9/16	9 1/2	Polyester	---	M	F8-134		6-11
32-20	4 7/8	12 9/16	9 1/2	Paper	---	M	F8-110		6-11
75P	5	11 3/4	8	Polyester	955	GN			6-11
74P	5	11 3/4	8	Paper	955	GN			6-11
101	5 1/8	6 5/8	4 1/2	Paper	205	M			6-11
32-19	5 1/8	10 3/16	7 1/8	Polyester	---	M	F8-135		6-11
32-18	5 1/8	10 3/16	7 1/8	Paper	---	M	F8-109		6-11
854	5 5/16	1 1/2	1/2	Paper	27	TB	C411		6-9
104	5 3/8	7 1/4	5 1/8	Paper	255	M			6-11
840	5 5/8	3 5/8	1 3/4	Paper	80	T	C1049		6-9
841	5 5/8	3 5/8	1 3/4	Polyester	80	T	C1049		6-9
870	5 5/8	1 15/16	1 1/8	Paper	30	TB	C69/1		6-9
144P	5 13/16	9 3/4	6	Paper	955	GN			6-11
32-07	6	9 3/4	7 1/4	Polyester	---	M	81-1205	F976	6-11
32-06	6	9 3/4	7 1/4	Paper	---	M	81-1063	P976	6-11
862	6 7/16	8 3/8	5 11/16	Paper	322	T	C21138/1		6-9
863	6 7/16	8 3/8	5 11/16	Polyester	322	T	C21138/1		6-9
836	6 9/16	2 1/2	1 1/2	Paper	48	TBHF	C718		6-9
32-09	7	11 1/2	9 7/8	Polyester	---	M	81-1206	F1197	6-11
32-08	7	11 1/2	9 7/8	Paper	---	M	81-0474	P1197	6-11
856	7 11/16	10	7 11/16	Paper	375	T	C26240		6-9
857	7 11/16	10	7 11/16	Polyester	375	T	C26240		6-9
896	8 7/16	4	2 3/8	Paper	115	TB			6-9
897	8 7/16	4	2 3/8	Polyester	115	TB			6-9
237	8 1/2	7 3/4	4 2/3	Polyester	550	GBN			6-7
236	8 1/2	7 3/4	4 2/3	Paper	550	GBN			6-7
32-11	8 5/8	13 5/8	11 5/8	Polyester	---	M	81-1207	F13118	6-11
32-10	8 5/8	13 5/8	11 5/8	Paper	---	M	81-04575	P13118	6-11
850	8 3/4	5 7/8	3 1/2	Paper	290	TR	C15124/1		6-9
851	8 3/4	5 7/8	3 1/2	Polyester	290	TR	C15124/1		6-9
231P	9 1/2	5 3/4	3 5/8	Polyester	300	M			6-7
230P	9 1/2	5 3/4	3 5/8	Paper	300	M			6-7
235P	9 5/8	7 7/8	4 3/4	Polyester	570	M			6-7
234P	9 5/8	7 7/8	4 3/4	Paper	570	M			6-7
245P	9 5/8	9 3/4	6	Polyester	880	GN			6-7
244P	9 5/8	9 3/4	6	Paper	880	M			6-7
275P	9 5/8	11 3/4	8	Polyester	1100	GN			6-7
274P	9 5/8	11 3/4	8	Paper	1100	GN			6-7
239P	10	9 1/4	4 7/8	Polyester	570	GBN			6-7
238P	10	9 1/4	4 7/8	Paper	570	GBN			6-7
32-23	10	12 9/16	9 1/2	Polyester	---	M	F8-139		6-11
32-22	10	12 9/16	9 1/2	Paper	---	M	F8-111		6-11
32-13	10	17	13	Polyester	---	M	81-1209	F171310	6-11
32-12	10	17	13	Paper	---	M	81-1163	P171310	6-11
32-25	14	19 3/4	15	Polyester	---	M	F8-148		6-11
32-24	14	19 3/4	15	Paper	---	M	F8-137		6-11
32-15	14	23	19	Polyester	---	M	81-1210	F231914	6-11
32-14	14	23	19	Paper	---	M	81-1164	P231914	6-11
335P	14 1/2	7 7/8	4 3/4	Polyester	800	M			6-7
334P	14 1/2	7 7/8	4 3/4	Paper	800	M			6-7
345P	14 1/2	9 3/4	6	Polyester	1100	GN			6-7
344P	14 1/2	9 3/4	6	Paper	1100	GN			6-7
375P	14 1/2	11 3/4	8	Polyester	1500	GN			6-7
374P	14 1/2	11 3/4	8	Paper	1500	GN			6-7
371P	14 1/2	13 3/4	10	Polyester	3060	GN			6-11
370P	14 1/2	13 3/4	10	Paper	3060	GN			6-11
377P	14 1/2	14 5/8	9	Polyester	1825	GN			6-7
376P	14 1/2	14 5/8	9	Paper	1825	GN			6-7
385P	14 1/2	19 5/8	14	Polyester	3300	GN			6-7
384P	14 1/2	19 5/8	14	Paper	3300	GN			6-7
391	14 1/2	27 7/8	22 1/4	Polyester	9350	GN			6-11
390	14 1/2	27 7/8	22 1/4	Paper	9350	GN			6-11
485P	21 1/2	19 5/8	14	Polyester	4705	GN			6-7
484P	21 1/2	19 5/8	14	Paper	4705	GN			6-7
491	21 1/2	27 7/8	22 1/4	Polyester	13600	GN			6-11
490	21 1/2	27 7/8	22 1/4	Paper	13600	GN			6-11
575P	24 1/2	11 3/4	8	Polyester	4250	GN			6-11
571P	24 1/2	13 3/4	10	Polyester	5100	GN			6-11
685P	28 1/2	19 5/8	14	Polyester	6600	GN			6-7



SpinMeister™ Precleaners Extreme Duty Filtration



Operating Principle

Intake air is drawn through the angled louver plates which direct to turn the rotor. The centrifugal force separates the contaminants from the airstream, throwing them to the outer perimeter of the cover, expelling them through the discharge port. Clean air then enters into your equipment.

General Specifications

- Temp (continuous): min -60°F (-51° C) max 250°F (121°C)
- 85%+ removal efficiency standard to 15 microns
- Heavy duty vibration resistant stainless steel clamp

Molded SpinMeisters

- Molded fiber filled composite housing
- Plastic rotors
- May be used with Solberg Inlet SpinMeister Filter Assemblies

Part Number	SCFM Flow Rating Range	Slip Fit Outlet	Dimensions - inches		
			HT	Slip Fit I.D.	Cover O.D.
SM-1.5	3-35	1.5"	2 1/4	1 1/2	3 1/2
SM-2	20-110	2"	3	2	4 3/4
SM-3	75-250	3"	4 1/2	3	7
SM-4	250-400	4"	5 3/8	4	9 3/8
SM-6	450-900	6"	7 1/4	6	12

Aluminum SpinMeisters

- Polished aluminum housing
- Stainless steel rotors
- May be used with Solberg Inlet SpinMeister Filter Assemblies

Part Number	SCFM Flow Rating Range	Slip Fit Outlet	Dimensions - inches		
			HT	Slip Fit I.D.	Cover O.D.
SMA-2	10-110	2"	3	2	4 3/4
SMA-3	140-300	3"	4 3/4	3	8 1/4
SMA-4	140-350	4"	4 3/4	4	8 1/4
SMA-6	400-850	6"	7 1/8	6	10 5/8
SMA-9	900-2000	9"	8 1/8	9	17 1/8

SpinMeisters for Vacuum

- Low pressure drop design
- Molded fiber filled composite housing
- Stainless steel rotors
- May be used with Solberg Vacuum Filter Series

Part Number	SCFM Flow Rating Range	Slip Fit Outlet	Dimensions - inches		
			HT	Slip Fit I.D.	Cover O.D.
SML235	40-110	3.5"	3 7/8	3 1/2	7 3/8
SML345	100-200	4.5"	7	4 1/2	10 1/4
SML445	200-450	4.5"	7 1/2	4 1/2	10 1/4

Dimension tolerance ± 1/4"

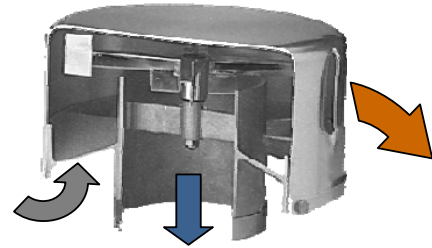

SpinMeister™ Airflow Schematic

