

MIDWEST "MARQUISE" MINILOADER™

DETAILS ARE SUBJECT TO CHANGE WITHOUT PRIOR NOTICE.
CAUTION: EXPLOSION PROOF CONSTRUCTION AVAILABLE
 CONSULT FACTORY FOR DETAILS AND PRICING

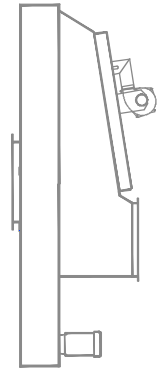
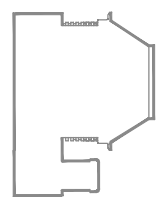
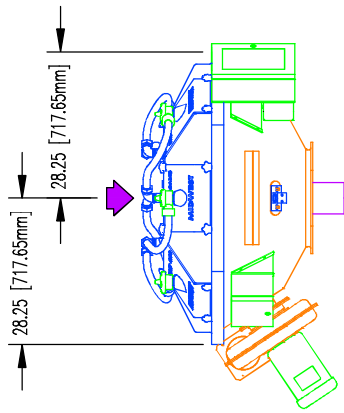
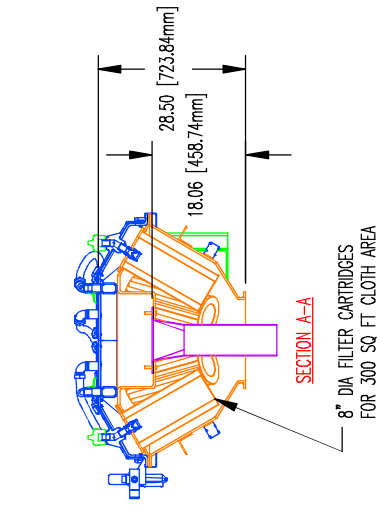
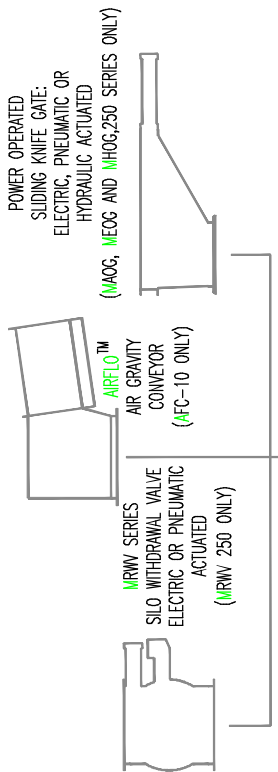
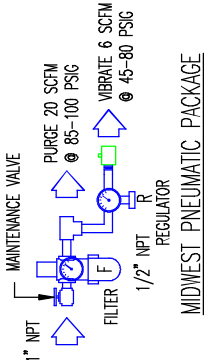
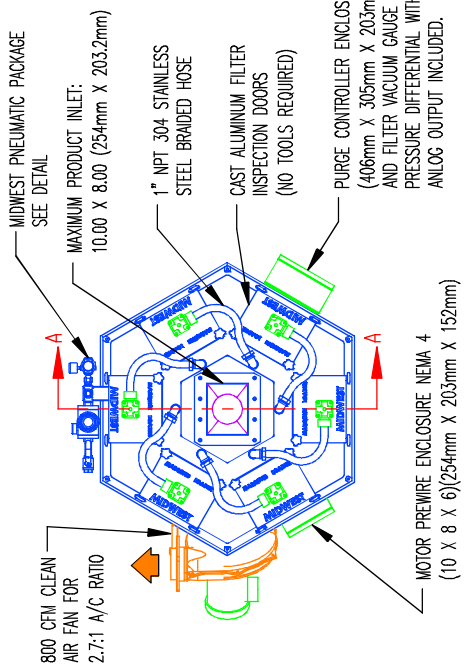

SPOUT POSITIONERS AVAILABLE

- MFPV FLAT TOP SPOUT POSITIONER (2 DIRECTION)
- MSPV SPOUT POSITIONER (1 DIRECTION)
- MFRSPV ROUNDABOUT™ SPOUT POSITIONER (ALL DIRECTIONS)

LOW PROFILE POSITIONER WITH AERATED HOPPER (AS SHOWN) REFER TO APPROPRIATE SALES DRAWING OR CONSULT FACTORY

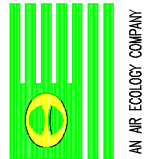

Operational Headquarters
 Midwest Plaza, 105 Slawer Rd.
 Charlevoix, Michigan 49720
 Phone (231) 547-4000
 Fax (231) 547-9453
 a division of ron pair enterprises, inc.

REF. SERIAL NO. JOB NO. SHEET NO. DRAWING NO. MML300C

PREPARED FOR: P.O. NO. TITLE: MARQUISE MINILOADER™ FILTER MODULE
 DRAWN: BW DATE: 25 JAN 13

DATE: CHECKED: WP

This drawing and/or publication represents proprietary article and the designs, trade names or trademarks therein are either patented, have patents pending or are copyrighted internationally. Information appearing on this document remains the property of Ron Pair Enterprises, Inc. and is not to be reproduced without written authorization from an officer of this corporation.

REVISION NO. DATE: