

Brute[®] Hydraulic Motor-Driven Vibrators

CCV Series

With an integral clamp foot, these powerful vibrators suit portable applications like railcar unloading.

DV Series

For permanent installation on large vessels, these vibrators come with four- or six-bolt-hole mount bases.

CV Series

CV Series Vibrators incorporate two bolt-holes for permanent mounting on hoppers, bins, or chutes. Also available for DC electric power.

CC Series

With its cradle lug bracket, the CC Series is suited for applications requiring portability and position changes.

Rule-of-thumb vibrator sizing:

One pound of vibrator force for every ten pounds of bin content. Mount vibrator as close as possible to material outlet. Reinforce mount area to prevent flexure of bin wall at mount location.

Force output data derived from vibrator mounted to 10,000-pound (4530 kg) test block. Frequency and force will decrease on less rigid block.

1. High-Grade Ductile Iron Case provides maximum durability.
2. Low-Maintenance Bearings require lubrication after 500 hours of service.
3. Integral Clamp Foot on CCV Series provides portability and positive mounting.
4. Powerful, Efficient Motor for long service life, minimal power consumption.
5. Adjustable Eccentrics allow tuning of force output of most models to match application.

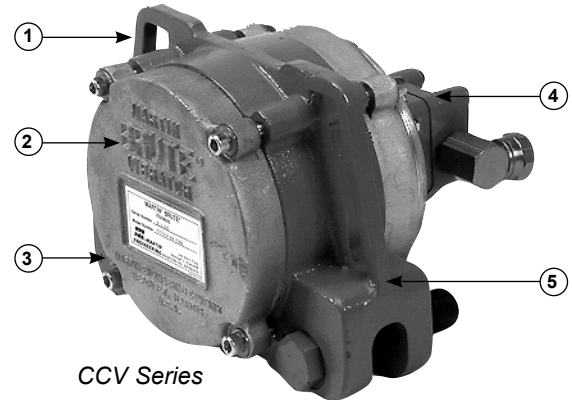

CCV Series



DV Series



CV Series



CC Series

PERFORMANCE DATA

| Model | Force Output | | | | Shipping Weight | | Part Number | |
|-------------|--------------|--------|---------|--------|-----------------|------|--------------------|---------------------|
| | Maximum | | Minimum | | | | w/Greased Bearings | w/Oil Bath Bearings |
| | lb | n | lb | n | lb | kg | | |
| CV2.0-2HB | 614 | 2731 | 41 | 182 | 23 | 10.4 | 32005 | — |
| CV2.8-5HB | 4715 | 20,973 | 910 | 4048 | 45 | 20.4 | 29765 | — |
| CC2.8-5HB | | | | | 52 | 23.6 | 29759 | — |
| CCV4-5HB | 4660 | 20,729 | 1000 | 4448 | 60 | 27.2 | 29775 | 29778 |
| DV4-5HB | | | | | 70 | 31.8 | 29768 | 29766 |
| CCV6-25-8HA | 8500 | 37,810 | 4400 | 19,572 | 110 | 50.0 | — | 22108-02 |
| DV6-25-8HA | | | | | 115 | 52.2 | 18137-02 | 22111-02 |
| CCV6-50-8HA | 9500 | 42,258 | 4500 | 20,017 | 110 | 50.0 | — | 22108-04 |
| DV6-50-8HA | | | | | 115 | 52.2 | 18137-04 | 22111-04 |

TECHNICAL DATA SHEET

DIMENSIONS

| Model | A | B | C | D | E | F | G | H | J |
|-------|---------------|---------------|----------------|-------------------------------------------|--------------|---------------|---------------|-----------------|-------------|
| CV2.0 | 8.0 (203) | 5.13 (130) | 7.78 (198) | 6.25 (159) | 2.0 (51) | N/A | 1.0 (25) | 0.5 (13) | 0.5 (13) |
| CC2.8 | 9.0 (229) | 7.12 (186) | 9.50 (241) | N/A | 3.0 (76) | 3.44 (86) | N/A | N/A | 0.5 (13) |
| CV2.8 | 9.87 (251) | 6.87 (174) | 9.81 (249) | 8.0 (203) | 3.0 (76) | 3.44 (86) | 0.875 (22) | 0.75 (19) | 0.5 (13) |
| CCV4 | 11.5 (292) | 8.25 (210) | 9.63 (245) | 8.25 (210) | 0.94 (24) | 4.12 (205) | N/A | N/A | 0.5 (13) |
| DV4 | 12.0 (305) | 8.12 (206) | 9.62 (244) | 4- holes 2.5 x 10.5 (63.5 x 267) | 4.0 (102) | 4.0 (102) | 0.875 (22) | 0.625 (15.0) | 0.5 (13) |
| CCV6 | 11.3 (287) | 11.3 (287) | 12.28 (312) | 11.25 (286) | 1.0 (25) | 5.62 (143) | N/A | N/A | 0.5 (13) |
| DV6 | 18.0 (457) | 11.0 (279) | 12.63 (321) | 6- holes 2 x 2 x 16 (51 x 51 x 406) | 6.0 (152) | 5.56 (141) | 1.12 (29) | 0.75 (19) | 0.5 (13) |

CCV Series

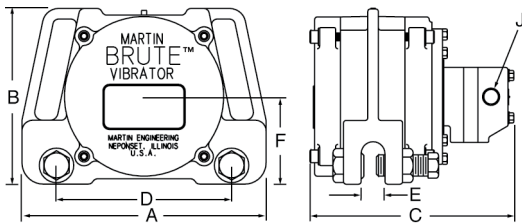

CC Series

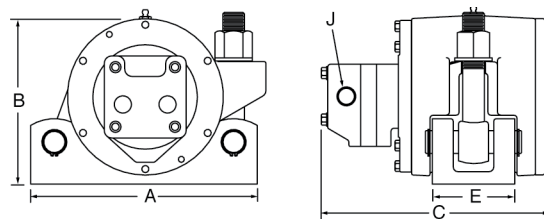

DV Series

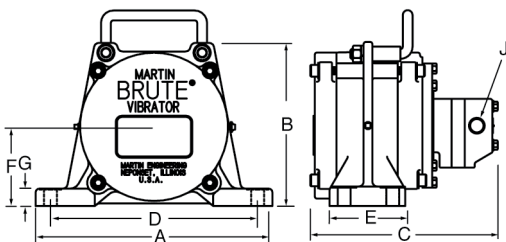

CV Series

